

LED T8 Tube Safety and Installation Instructions





Please read these instructions thoroughly before use and retain for future reference.

- * The T8 LED lamp is made up of T8 LED tube and LED starter
- * The T8 LED lamp is used for replacing the T8 fluorescent lamps:
 T8-LED-9W replaces T8 fluorescent lamp 18W
 T8-LED-18W replaces T8 fluorescent lamp 36W
 T8-LED-24W replaces T8 fluorescent lamp 58W

- * The T8 LED working temperature is -20 °C to 40 °C
- * No modifications of the luminaire which the LED lamp is to be used with are to be made.

This lamp may not be suitable for use in all applications where a traditional fluorescent lamp has been used. The temperature range of this lamp is more restricted. In cases of doubt regarding the suitability of the application the manufacturer of this lamp should be consulted.

- * This lamp is designed for general lighting service (excluding for example explosive atmospheres).

	Lamp is suitable for use in luminaires with magnetic ballasts.		Lamp should be used in dry conditions or in a luminaire that provides protection.
	Lamp is not suitable for use in emergency luminaires designed for double-capped fluorescent lamp(s).		Lamp is not dimmable.

Operating instructions of light replacement(Magnetic Ballast)

Schematic steps of removing a fluorescent lamp and inserting a double-capped LED lamp designed to retrofit linear fluorescent lamp

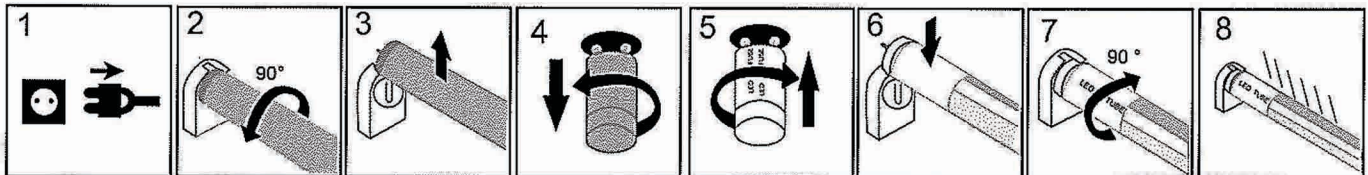

- 1) Switch off electricity.
- 2) and 3) Remove the conventional lamp.
- 4) Remove the starter.
- 5) Click the LED replacement starter into the starter holder.
- 6) Insert the LED lamp into the lampholder.
- 7) Secure the position by turning the lamp by 90 ° .
- 8) Switch on electricity and check for lam starting.

Operating instructions: (Diagram)

1.Installation of new light

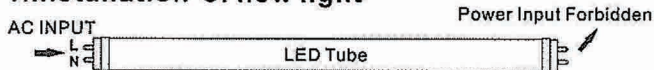

2.Installation of light replacement (Magnetic Ballasts)

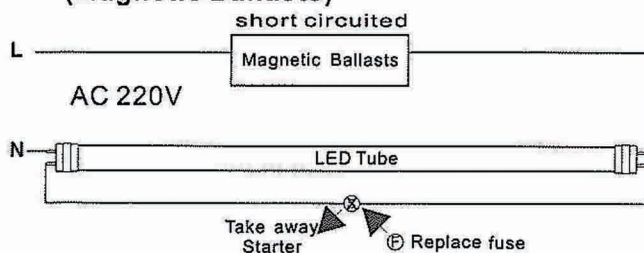

3.Installation of light replacement (Electronic Ballasts)

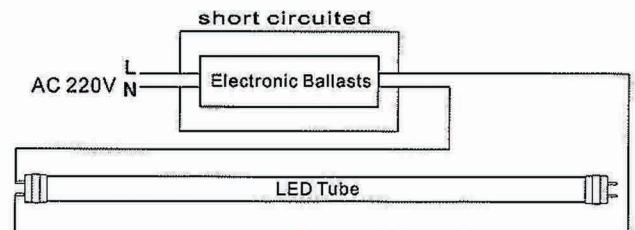

PS: Unprofessional staff are not allowed to operate!



Title

T8L Performance Requirements

Version: A0

Page: 1/1

Specification

T8L-IDHH23-2400-5ft-XBX**Market:****1 Dimensions & Cap**

	Referenced standard	Dimension	Min	Max	Unit
	IEC60081	A	/	1500.0	mm
		B	1504.7	1507.1	mm
		C	/	1514.2	mm
		D	25.0	26.0	mm
		Cap	G13		

2 Electrical Characteristics

Parameter	Symbol	Testing condition and method	Referenced standard	Rated	Tolerance	Unit
Rated Power	P	Temperature:25°C±5°C Humidity:≤65% No air circulation;	IEC/PAS 62612	24	±10%	W
Input Voltage	U			220	/	V
Line frequency	f			50	/	Hz
Power Factor	PF			0.90	-3%	/
Ignition Time	t			≤0.5		s

3 Photometrical Characteristics

Parameter	Symbol	Testing condition and method	Referenced standard	Rated	Tolerance	Unit
Lumen-3000K/3500K	Φ	Temperature:25°C±5°C Humidity:≤65% No air circulation;	IEC/PAS 62612	2160	-10%	lm
Lumen-/4000K/5000K/6500K				2400		
Efficacy-3000K/3500K	η			90	-10%	lm/W
Efficacy-/4000K/5000K/6500K				100		

4 Color Characteristics

Parameter (Color)	Symbol	Testing condition and method	Referenced standard	Rated	Tolerance	Unit
CCT-3000K	CCT	Temperature:25°C±5°C Humidity:≤65% No air circulation;	IEC/PAS 62612	x=0.440 y=0.403		
CCT-3500K				x=0.409 y=0.394		
CCT-4000K				x=0.380 y=0.380		
CCT-5000K				x=0.346 y=0.359		
CCT-6500K				x=0.313 y=0.337		
CRI	Ra			82	-3	
Color tolerance	/	≤5		SDCM		

5 Lumen maintenance & Life

Parameter	Symbol	Testing condition and method	Referenced standard	Rated	Unit
6000hrs Lumen Maintenance	/	Temperature:25°C±5°C Humidity:≤65% No air circulation;	IEC/PAS 62612	92.0%	/
Life	t			40,000	h

Draft
(Date)Audit
(Date)Countersign
(Date)Approval
(Date)