

## Centronics Socket and Pin 180° IDC-Type

### Technical data :

Material shell            Steel tin-coat over nickel  
 Insulator                Thermoplastic polyester  
 Color Insulator        Black  
 Burning properties     Self extinguishing rated UL94V0  
 Contact                  Copper alloy  
 Contact surface        Gold over nickel  
 Operating temperature   -55°C to +125°C

Electrical data :  
 Current rating            5 A  
 Electrical rating        500V eff.  
 Insulation resistance    1000Mohm min. 500V DC



### Female-Cable to panel type

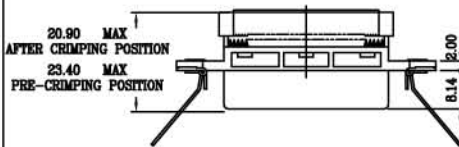

### Male-Cable to panel type

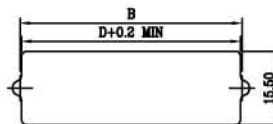
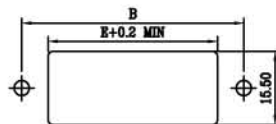
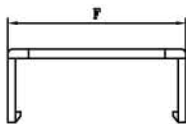
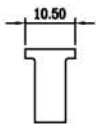
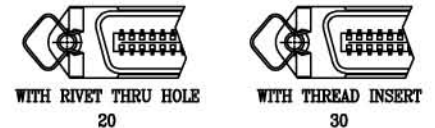
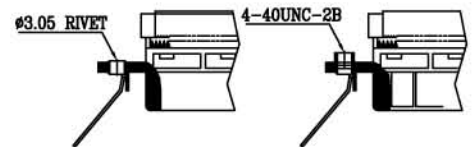
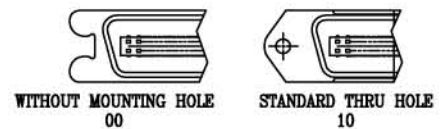
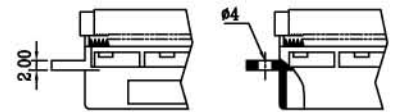
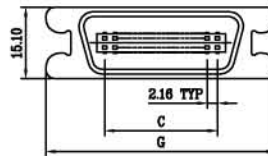
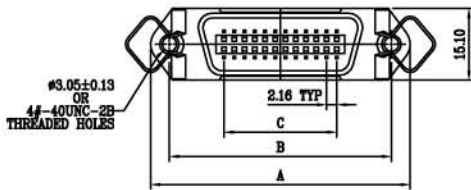
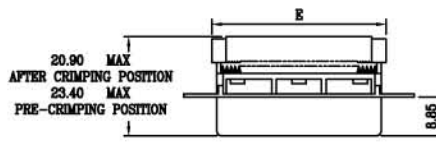

### How to order

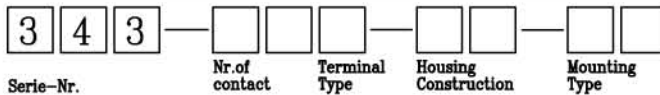

Nr. of contact	Dimensions(mm)						
	A	B	C	D	E	F	G
	±0.25	±0.13	±0.13	±0.25	±0.25	±0.25	±0.25
24	54.70	46.78	23.76	45.95	35.50	37.50	48.60
36	67.80	59.74	36.72	58.80	53.30	54.40	61.60
50	82.80	74.85	51.84	74.25	68.50	70.50	76.70

Terminal Type	Code
Pin	1
Socket	2

Housing construction	Code
All plastic	00
With metal front shell	10

Mounting Type	Code
Without Mounting Hole	00
Standard through Hoie	10
With rivet through Hole	20
With UNC 4-40 Thread insert	30