

SPECIFICATION

LEAD FREE

CUSTOMER : TOP	APPROVED BY
CUS. PART NO. :	
COILS PART NO. : A010-845298NP	
DATE : 2006/03/20	

1. DIMENSIONS (UNIT : mm)

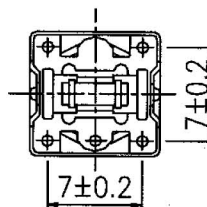
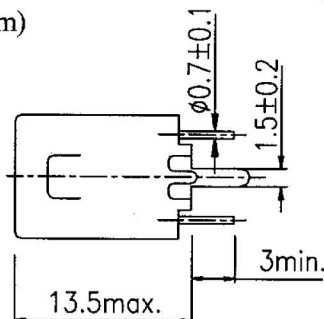
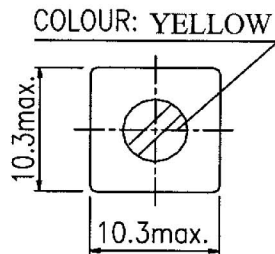

STAMP

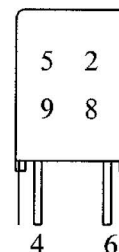

2. CONNECTION (BOTTOM)

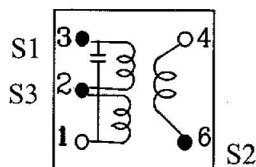

3. TURNS , WIRE AND CORE

PIN. NO.	3 - 2	6 - 4	2 - 1	
TURNS (Ref.)	71 T	8 T	77 T	
WIRE	Ø0.08mm(2UEW)			
DRUM CORE	ED3B	OR EQUIVALENT		
CAP CORE	EQ2M	OR EQUIVALENT		

4. CHARACTERISTICS

ITEM	SPEC (1 - 3)	TESTING CONDITION	MEASUREMENT INSTRUMENT
CENTER FREQUENCY	455kHz		
VARIABLE FERQUENCY	455kHz±3% Min.		MQ-1601
UNLOADED Q	105 Min.	455kHz	MQ-1601
INT. CAPACITY	180pF±5%		

EXT. CAP 0 pF (1-3)

5. GENERAL CHARACTERISTICS:

- ① Core Torque : 50 ~ 400gf · cm
- ② Dielectric Strength: No abnormality at 100V D.C. for 1 minute between winding-winding, winding-case.
- ③ Insulation Resistance: Over 100MΩ at 100V D.C. between winding-winding, winding-case.
- ④ Humidity Test : Frequency (Inductance) deviation within ±0.5% (±1%)
Deviation of Q within ±20%
After 96±4 hours in 90~95% relative humidity at 40°C±2°C and 60 minutes drying under normal condition.
- ⑤ Temperature Test : Frequency (Inductance) deviation within ±0.5% (±1%)
Deviation of Q within ±20%
a. After 6 hours at -25°C±3°C and 1 hour later under normal condition.
b. After 6 hours at 85°C±2°C and 1 hour later under normal condition.
- ⑥ Terminal Strength : No abnormality at 0.5kg for 30±5 seconds (pull and push).
- ⑦ Terminal Heat Test: No abnormality at 250°C±5°C for 5 seconds.

6. RoHS COMPLIANCE REMARKS: LEAD WILL BE PRESENT IN THE FERRITE CORE OF THE FRIT MATRIX IN THE COMPONENT. THIS USE, IS EXEMPT FROM RoHS LEGISLATION PER THE ANNEX (ITEM7), WHICH REFERS TO "LEAD IN ELECTRONIC CERAMIC PART".

SPECIFICATION

LEAD FREE

CUSTOMER : TOP	APPROVED BY
CUS. PART NO. :	
COILS PART NO. : A010-845298NP	
DATE : 2006/03/20	

7. CONSTRUCTION

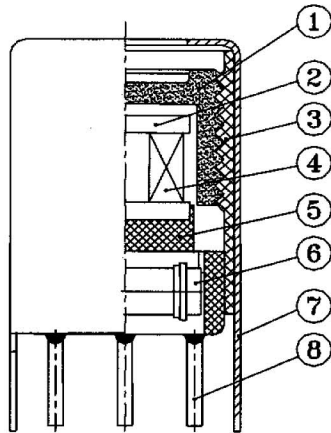

8. MATERIAL LIST

No.	PARTS	MATERIAL	MANUFACTURER	COUNTRY OF ORIGIN	UL No.	UL FLAME CLASS
①	CAP CORE	FERRITE CORE EQ2M OR EQUIVALENT	TONICHI FERRITE PRODUCTS CO., LTD.	CHINA	NA	NA
②	DRUM CORE	FERRITE CORE ED3B OR EQUIVALENT	TONICHI FERRITE PRODUCTS CO., LTD.	CHINA	NA	NA
③	HOLDER	POLYPROPYLENE (PP-6331) OR EQUIVALENT	HMC POLYMERS CO., LTD.	THAILAND	NA	NA
④	WIRE	POLYURETHANE ENAMELLED COPPER WIRE OR EQUIVALENT	PACIFIC-THAI ELECTRIC WIRE & CALBE CO., LTD.	THAILAND	E142108	NA
			JUNG SHING WIRE CO., LTD.	CHINA (TAIWAN)	E174837	NA
⑤	BASE	PF-T373J OR EQUIVALENT	CHANG CHUN PLASICS CO., LTD.	CHINA	E59481	94V-0
⑥	CAPACITOR	CERAMIC OR EQUIVALENT	TONICHI FERRITE PRODUCTS CO., LTD.	CHINA	NA	NA
⑦	CASE	BRASS H68 OR EQUIVALENT	TONICHI FERRITE PRODUCTS CO., LTD.	CHINA	NA	NA
⑧	LEAD PIN	H.C.P. OR EQUIVALENT	WELL FORE SPECIAL WIRE CORPORATION	CHINA (TAIWAN)	NA	NA
	SOLDER	Sn99.3-Cu0.7 OR EQUIVALENT	ALPHA METALS LTD.	CHINA (HONG KONG)	NA	NA
	STAMP	INK(STM-3) OR EQUIVALENT	SHACHIHATA CO.,LTD.	JAPAN	NA	NA
	VARNISH	642 OR EQUIVALENT	P D GEORGE CO.	USA	E73015	NA
	ADHESIVE	EPOXY RESIN (6016H-7A) OR EQUIVALENT	GUANG ZHOU WELLS CHEMICAL CO., LTD.	CHINA	NA	NA
	PAINT	ACRYLIC EPOXY (PU#1700 YELLOW) OR EQUIVALENT	FINECHEN INDUSTRIAL (SHEN ZHEN) CO., LTD.	CHINA	NA	NA